

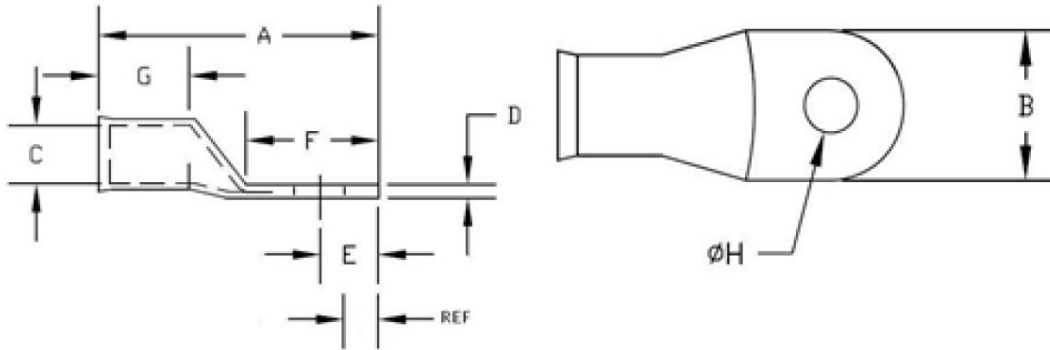

Plated Tubular Lugs Specifications Sheet

OUTLINE DRAWING



NOTES

PART #	CABLE SIZE	DESCRIPTION	OVERALL LENGTH	PAD WIDTH	BARREL ID	PAD THICKNESS	FROM CENTRE STUD HOLE	TANG LENGTH	BARREL LENGTH	STUD HOLE SIZE	REFERENCE
			+/- .035"	+/- .025"	+/- .010"	+/- .010"	+/- .020"	MIN	MIN	+/- .012"	+/- .020"
			A	B	C	D	E	F	G	H	REF
4035	8 GA	.445" Pad Width #10 Stud	1.200	0.445	0.186	0.070	0.235	0.550	0.400	0.212	0.129
4036	8 GA	.445" Pad Width 1/4" Stud	1.200	0.445	0.186	0.070	0.235	0.550	0.400	0.276	0.097
4038	8 GA	.605" Pad Width 5/16" Stud	1.305	0.605	0.186	0.070	0.315	0.690	0.400	0.338	0.146
4039	8 GA	.605" Pad Width 3/8" Stud	1.305	0.605	0.186	0.070	0.315	0.690	0.400	.407+/--.007	0.112
4043	8 GA	.765" Pad Width 1/2" Stud	1.480	0.765	0.186	0.070	0.395	0.830	0.400	0.522	0.134
4135	6 GA	.445" Pad Width #10 Stud	1.305	0.445	0.232	0.075	0.235	0.550	0.425	0.212	0.129
4136	6 GA	.445" Pad Width 1/4" Stud	1.305	0.445	0.232	0.075	0.235	0.550	0.425	0.276	0.097
4138	6 GA	.605" Pad Width 5/16" Stud	1.410	0.605	0.232	0.075	0.320	0.690	0.425	0.338	0.151
4139	6 GA	.605" Pad Width 3/8" Stud	1.410	0.605	0.232	0.075	0.320	0.690	0.425	.407+/--.007	0.117
4143	6 GA	.765" Pad Width 1/2" Stud	1.550	0.765	0.232	0.075	0.395	0.830	0.425	0.522	0.134
4235	4 GA	.525" Pad Width #10 Stud	1.500	0.525	0.286	0.080	0.275	0.650	0.475	0.212	0.169
4236	4 GA	.525" Pad Width 1/4" Stud	1.500	0.525	0.286	0.080	0.275	0.650	0.475	0.276	0.137
4238	4 GA	.525" Pad Width 5/16" Stud	1.500	0.525	0.286	0.080	0.275	0.650	0.475	0.338	0.106
4239	4 GA	.625" Pad Width 3/8" Stud	1.530	0.625	0.286	0.080	0.325	0.695	0.475	.407+/--.007	0.122
4243	4 GA	.765" Pad Width 1/2" Stud	1.675	0.765	0.286	0.110	0.395	0.830	0.475	0.522	0.134
4336	2 GA	.615" Pad Width 1/4" Stud	1.615	0.615	0.336	0.095	0.325	0.700	0.525	0.276	0.187
4338	2 GA	.615" Pad Width 5/16" Stud	1.615	0.615	0.336	0.095	0.325	0.700	0.525	0.338	0.156
4339	2 GA	.615" Pad Width 3/8" Stud	1.615	0.615	0.336	0.095	0.325	0.700	0.525	.407+/--.007	0.122
4343	2 GA	.755" Pad Width 1/2" Stud	1.750	0.755	0.336	0.110	0.395	0.830	0.525	0.522	0.134
4836	1 GA	.655" Pad Width 1/4" Stud	1.720	0.655	0.360	0.100	0.330	0.710	0.575	0.276	0.192
4838	1 GA	.655" Pad Width 5/16" Stud	1.720	0.655	0.360	0.100	0.330	0.710	0.575	0.338	0.161



Plated Tubular Lugs Specifications Sheet

NOTES

PART #	CABLE SIZE	DESCRIPTION	OVERALL LENGTH	PAD WIDTH	BARREL ID	PAD THICKNESS	FROM CENTRE STUD HOLE	TANG LENGTH	BARREL LENGTH	STUD HOLE SIZE	REFERENCE
			+/- .035"	+/- .025"	+/- .010"	+/- .010"	+/- .020"	MIN	MIN	+/- .012"	+/- .020"
			A	B	C	D	E	F	G	H	REF
4839	1 GA	.655" Pad Width 3/8" Stud	1.720	0.655	0.360	0.100	0.330	0.710	0.575	.407+/--.007	0.127
4843	1 GA	.755" Pad Width 1/2" Stud	1.830	0.755	0.360	0.100	0.395	0.830	0.575	0.522	0.134
4436	1/0 GA	.725" Pad Width 1/4" Stud	1.830	0.725	0.407	0.110	0.380	0.760	0.625	0.276	0.242
4438	1/0 GA	.725" Pad Width 5/16" Stud	1.830	0.725	0.407	0.110	0.380	0.760	0.625	0.338	0.211
4439	1/0 GA	.725" Pad Width 3/8" Stud	1.830	0.725	0.407	0.110	0.380	0.760	0.625	.407+/--.007	0.177
4443	1/0 GA	.825" Pad Width 1/2" Stud	1.900	0.825	0.407	0.110	0.425	0.860	0.625	0.522	0.164
4536	2/0 GA	.815" Pad Width 1/4" Stud	2.060	0.815	0.461	0.110	0.425	0.900	0.650	0.276	0.287
4538	2/0 GA	.815" Pad Width 5/16" Stud	2.060	0.815	0.461	0.110	0.425	0.900	0.650	0.338	0.256
4539	2/0 GA	.815" Pad Width 3/8" Stud	2.060	0.815	0.461	0.110	0.425	0.900	0.650	.407+/--.007	0.222
4543	2/0 GA	.815" Pad Width 1/2" Stud	2.060	0.815	0.461	0.110	0.425	0.900	0.650	0.522	0.164
4636	3/0 GA	.895" Pad Width 1/4" Stud	2.160	0.895	0.511	0.120	0.465	0.940	0.675	0.276	0.327
4638	3/0 GA	.895" Pad Width 5/16" Stud	2.160	0.895	0.511	0.120	0.465	0.940	0.675	0.338	0.296
4639	3/0 GA	.895" Pad Width 3/8" Stud	2.160	0.895	0.511	0.120	0.465	0.940	0.675	.407+/--.007	0.262
4643	3/0 GA	.895" Pad Width 1/2" Stud	2.160	0.895	0.511	0.120	0.465	0.940	0.675	0.522	0.204
4736	4/0 GA	.590" Barrel ID 1/4" Stud	2.390	1.035	0.590	0.130	0.525	1.040	0.700	0.276	0.387
4738	4/0 GA	.590" Barrel ID 5/16" Stud	2.390	1.035	0.590	0.130	0.525	1.040	0.700	0.338	0.356
4739	4/0 GA	.590" Barrel ID 3/8" Stud	2.390	1.035	0.590	0.130	0.525	1.040	0.700	.407+/--.007	0.322
4743	4/0 GA	.590" Barrel ID 1/2" Stud	2.390	1.035	0.590	0.130	0.525	1.040	0.700	0.522	0.264
Material	Annealed Copper per ASTM B-152										
Finish	Tin Plated per ASTM B-545. Parts are free of burrs and sharp edges.										
Identification	Gauge size and certification marks are stamped on the tang.										
Dimensions	All dimensions are in inches unless otherwise specified.										

