

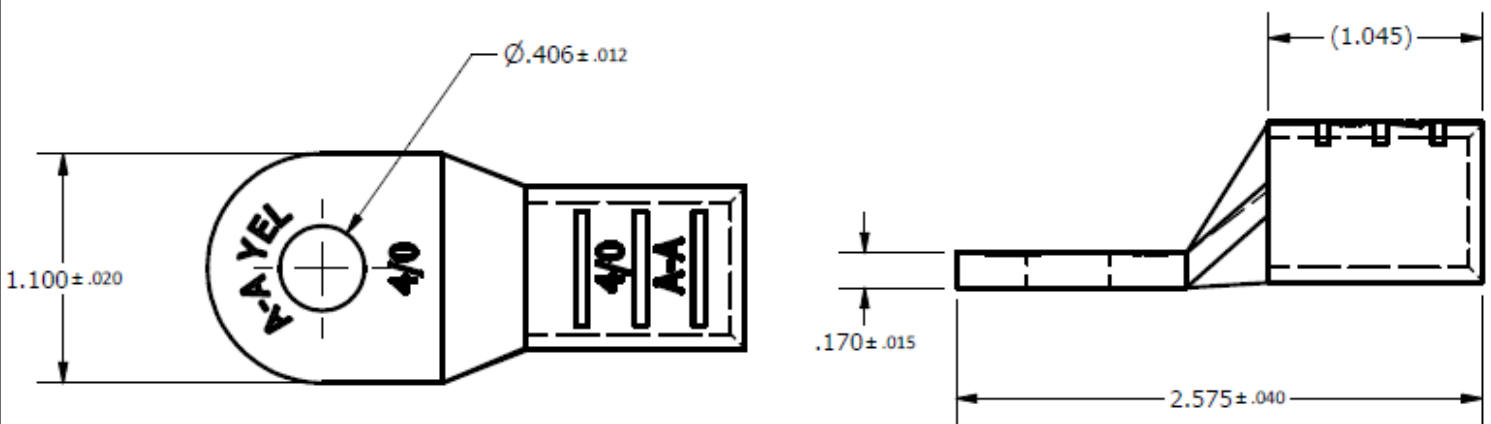

PICO[®]

5323 Specifications Sheet

Outline Drawings



Mounting

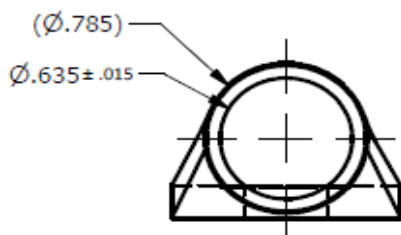

Drawing

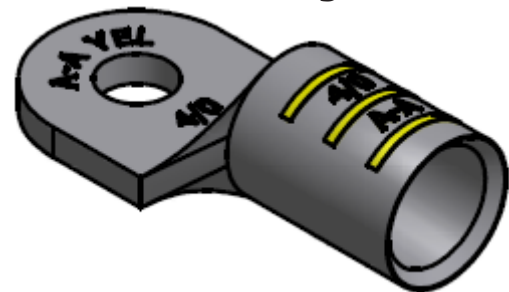

Notes

- Dimensions are in Inches
- Material: C11000 ETP COPPER
- Plating : Electro Tin .0002" - .0003"
- Tolerances Unless otherwise specified:

2 PL. DEC. ±.030
3PL. DEC. ±.015

True C.L. ±.015
Angles ±1