

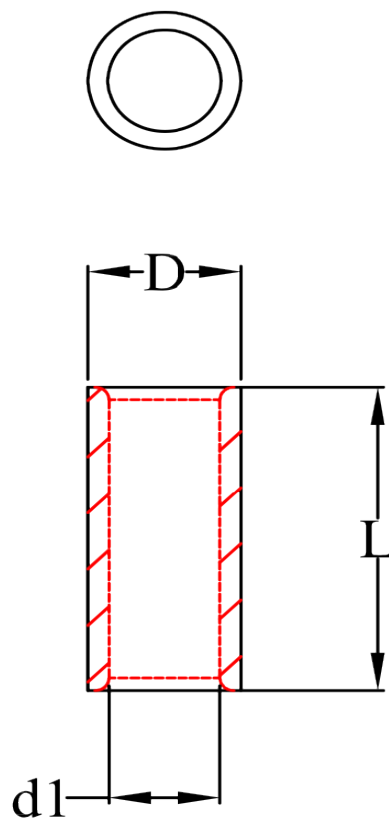

PICO[®]

2701 Specifications Sheet

Outline Drawings



Copper Thickness: t

Part #	Wire Gauge	Dimensions (mm)			
		L (± 0.60)	d1 (± 0.30)	D (± 0.30)	t (± 0.30)
2701	16-14 AWG	8.00	2.40	4.00	0.80

Notes

- Material: Copper
- Insulation: Non-Insulated
- Amperage Rating: 27A

