

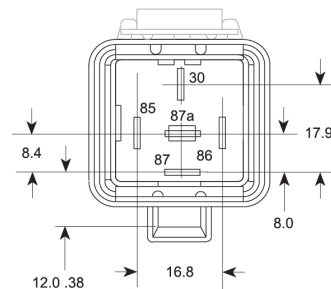

PICO®

929 Specifications Sheet Outline Drawing

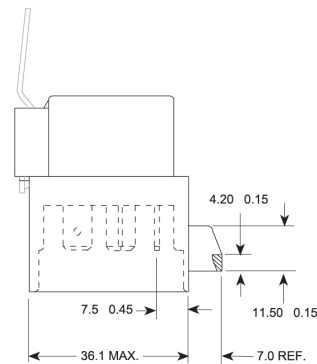
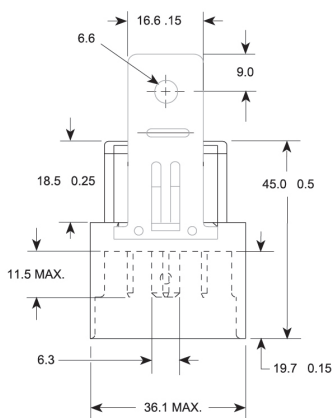
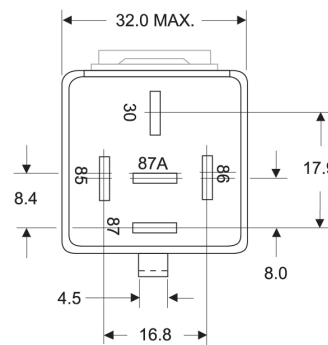
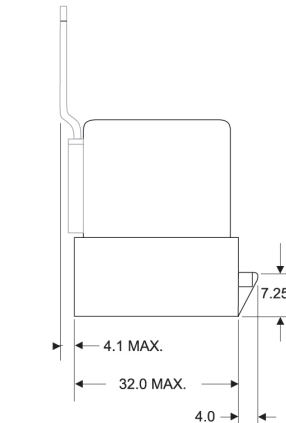
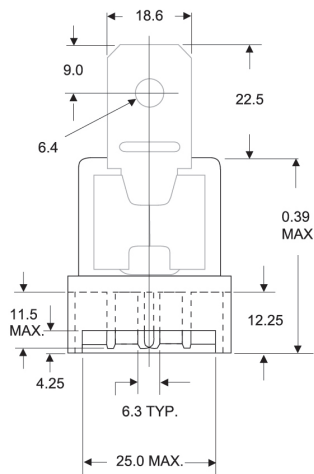

Max. DC load breaking capacity

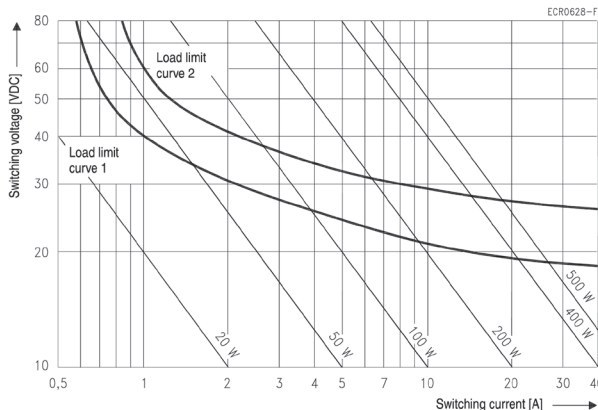

Load limit curve 1: arc extinguishes during transit time (changeover contact).
Load limit curve 2: safe shutdown, no stationary arc (make contact).
Load limit curves measured with low inductive resistors verified for 1000 switching events.

929

Specifications Sheet

Contact Data

(1) The values apply to a resistive or inductive load with suitable spark suppression and at maximum 3s for a make/break ratio of 1:10.

(2) Current and time are compatible with circuit protection by a typical automotive fuse. Relay will make, carry and break the specified current.

(3) For unsuppressed relay coil. A low resistive suppression device parallel to the relay coil increases the release time and reduces the lifetime caused by increased erosion and/or higher risk of contact tack welding.

Terminal Assignment

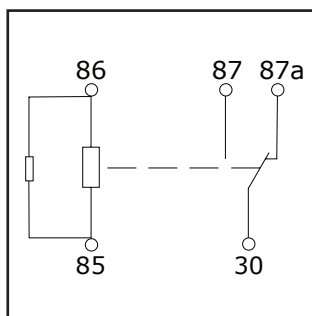

Coil Data

Rated Coil Voltage

12/24VDC

Coil Versions, DC Coil

Coil Code	Rated Voltage VDC	Operating Voltage VDC	Release Voltage VDC	Coil Resistance ⁽⁵⁾ Ω±10%	Rated Coil Power ⁽⁵⁾
F	12	7.2	1.2	90	1.6
H	24	14.4	2.4	360	1.6

5) WITHOUT COMPONENTS IN PARALLEL.

ALL FIGURES ARE GIVEN FOR COIL WITHOUT PRE-ENERGIZATION, AT AMBIENT TEMPERATURE +23°C.

Contact Arrangement	1 form C, 1CO
Rated Voltage	12VDC
Limiting continuous current, form A / form B	NO/NC
23°C	60/45A
85°C	40/30A
125°C	17/12A
Limiting Making Current⁽¹⁾, form A / form B	120/45A
Limiting Breaking Current, form A / form B	60/40A
Limiting Short-Time Current Overload current	1.35 x 40A, 1800s 2.00 x 40A, 60s 6.00 x 40A, 1s
Jump Start Test	24VDC for 5min, Conducting nominal current at 23°C
Contact Material	Silver Based
Min. Recommended Contact Load⁽³⁾	1A at 5VDC
Initial Voltage Drop, form A (NO) Contact at 40A, typ./ max.	60/200mV
form B (NC) Contact at 30A, typ./ max.	60/250mV
Frequency of Operation at Nominal Load	6 ops./min. (0.1Hz)
Operate/Release Time typ.	7/2ms ⁽⁴⁾
Electrical Endurance	>1x10 ⁵ ops.
Resistive Load, form A (NO) contact	40A, 14VDC
Resistive Load, form B (NC) contact	30A, 14VDC
Mechanical Endurance	>1x10 ⁶ ops.